

# **MOBICON**

## **Electronic Components**

### **PRODUCT SPECIFICATION**

### **MEC QUARTZ CRYSTAL**

### **FREQUENCY COMPONENTS**

**DT26 Series QUARTZ CRYSTAL SPECIFICATION**

<b>MOBICON HOLDINGS LTD.</b>		
<b>Prepared By</b>	<b>Sign.</b>	<b>Approved By</b>
Leo Wong		C.H. Wong

**[www.mobicon.com](http://www.mobicon.com)**

# MIEC

## SPECIFICATION OF CRYSTAL UNIT

**PART NO. :**

**DT26-75k12.520F**

### ELECTRICAL CHARACTERISTICS

1. Nominal Frequency	75 kHz
2. Holder Type	DT 26
3. Frequency Tolerance	$\pm 20$ ppm
4. Equivalent Resistance	30k Ohm max.
5. Insulation Resistance	500M Ohm @100V <sub>DC</sub>
6. Temperature Tolerance	$\pm 50$ ppm at $-10 \sim +60^{\circ}\text{C}$
7. Operating Temperature Range	$-10 \sim +60^{\circ}\text{C}$
8. Storage Temperature Range	$-10 \sim +70^{\circ}\text{C}$
9. Loading Capacitance	12.5 pF
10. Drive Level	1 uW max.
11. Aging	$\pm 5$ ppm/ year max.
12. Oscillation Mode	Fundamental

### DIMENSIONS (mm)

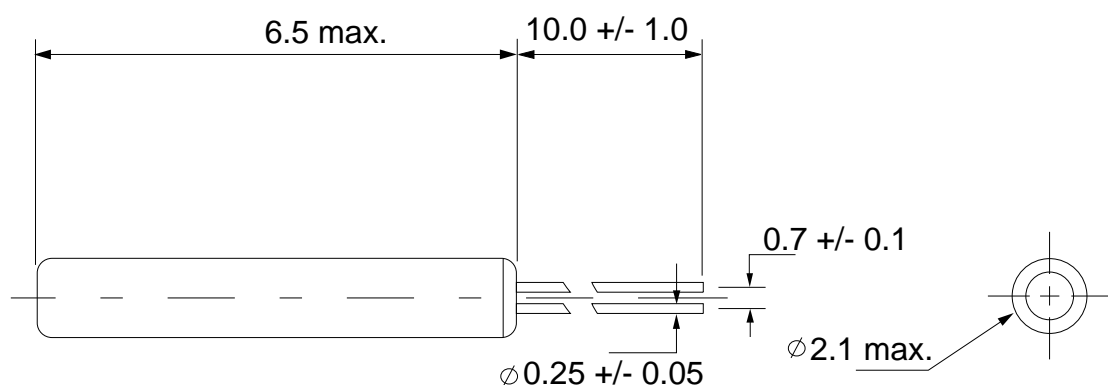

Prepared By: Leo Wong

DOC. No: DT26-75kHz12.5pF20ppmF